

JC261P Dash Camera

(User Manual)



Email: amazon@jimiiot.com

Website: www.Incoon.com

Tracking Platform: Incoon.com/download



Content List

| | |
|--|-----------|
| Appearance | 3 |
| Accessories | 3 |
| Hardwire Connection | 4 |
| Wiring Diagram | 6 |
| Install SIM & TF Card | 7 |
| Download App | 8 |
| Sign up & Log in | 9 |
| Add Device | 10 |
| Confirm SIM Connection | 12 |
| Ensure Device Online | 13 |
| Status Indicator | 13 |
| Device Inactive | 13 |
| Device Offline | 13 |
| Install Camera | 14 |
| Install Accessories | 15 |
| Set up with WiFi Kit | 16 |
| Get Help | 16 |
| App Instruction | 17 |
| Media Center | 18 |
| Live Stream | 19 |
| Event Video Setting | 20 |
| Real Time Tracking | 21 |
| History Playback | 22 |
| Geo Fence | 23 |
| Alert Setting | 24 |
| FAQ | 25 |
| LED Indicators | 26 |

Appearance



Accessories

- Kindly note that JC261P does not support DMS.



Screwdriver*1



Card Lock*1



Hardwire Cable*1



Screw*2



Windshield
3M Mount *1



External SOS Key*1



Relay*1

Hardwire Connection

- Wire Definition:

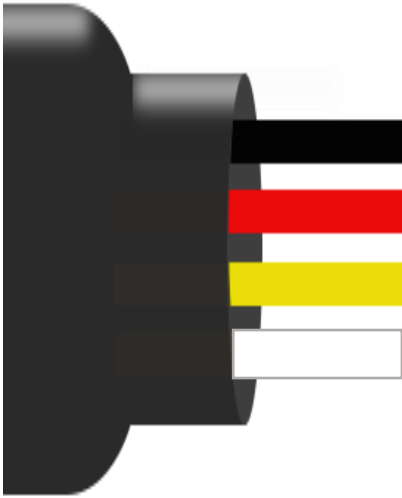

| | | |
|--------|--------|----------------------|
| GND | Black | Battery - (Negative) |
| B+ | Red | Battery + (Positive) |
| ACC | Yellow | ACC Detection |
| Replay | White | Remote Fuel Cut |

- Install Video: [JC261P Install Guide](#)

- How to connect:

1. **Connect Power Supply:** Take out the attached wire, connect the red end to the positive of the car battery, and the black end to the negative.

If the device is powered on successfully, the **red LED** will light up.

(When the engine is turned on, a 12V voltage can be detected with a multimeter between the positive and negative)

2. **ACC Detection:** Connect the yellow end to the ACC fuse to ensure the engine detection works correctly.

3. **Remote Power Cut-off (Optional):**

(i) Find the fuel tank wire and cut it in two at the proper location.



(ii) Twist the white end and the green (87a) end together and connect to the end of the oil pump wire near the ACC fuse.

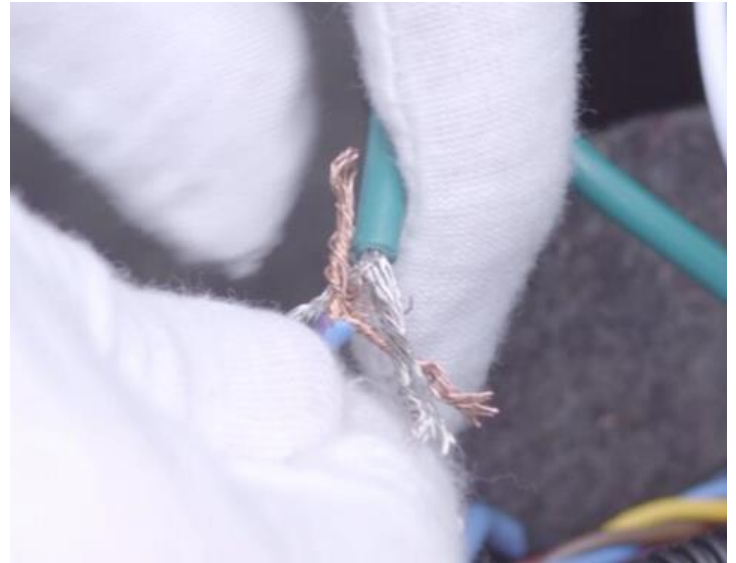

(iii) Connect the green (30) end to the end of the oil pump wire near the oil pump.

(iv) Connect the White end(camera end) to the yellow end(86) of the relay to ensure the fuel cut-off works correctly.

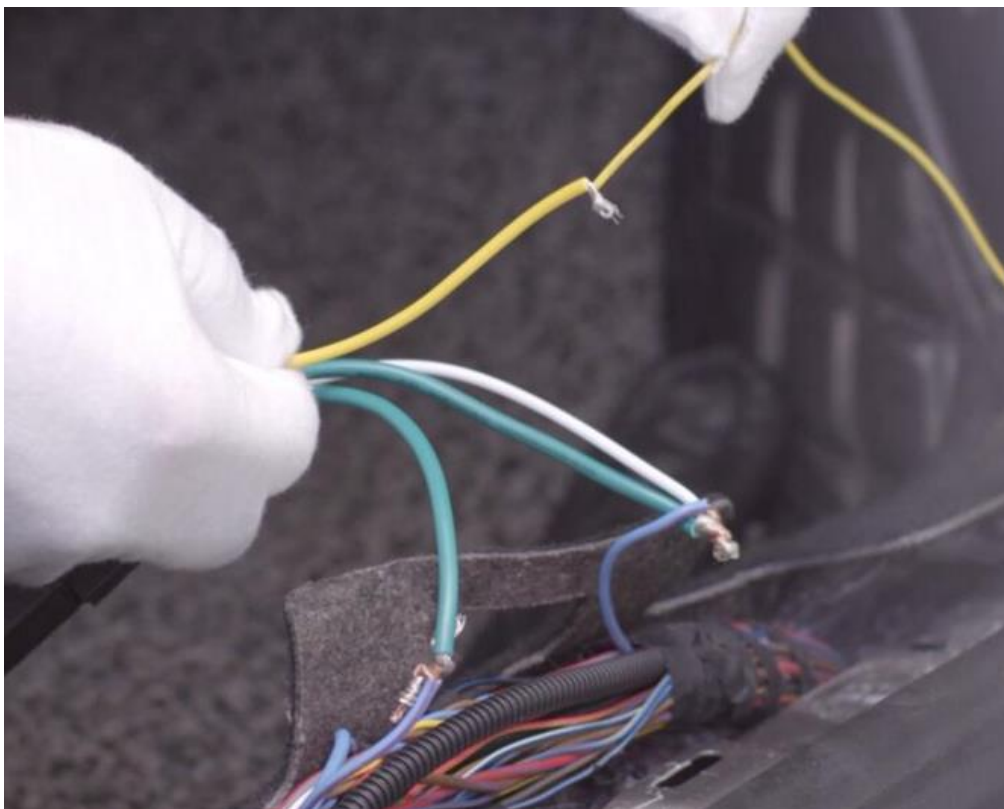

Wiring Diagram

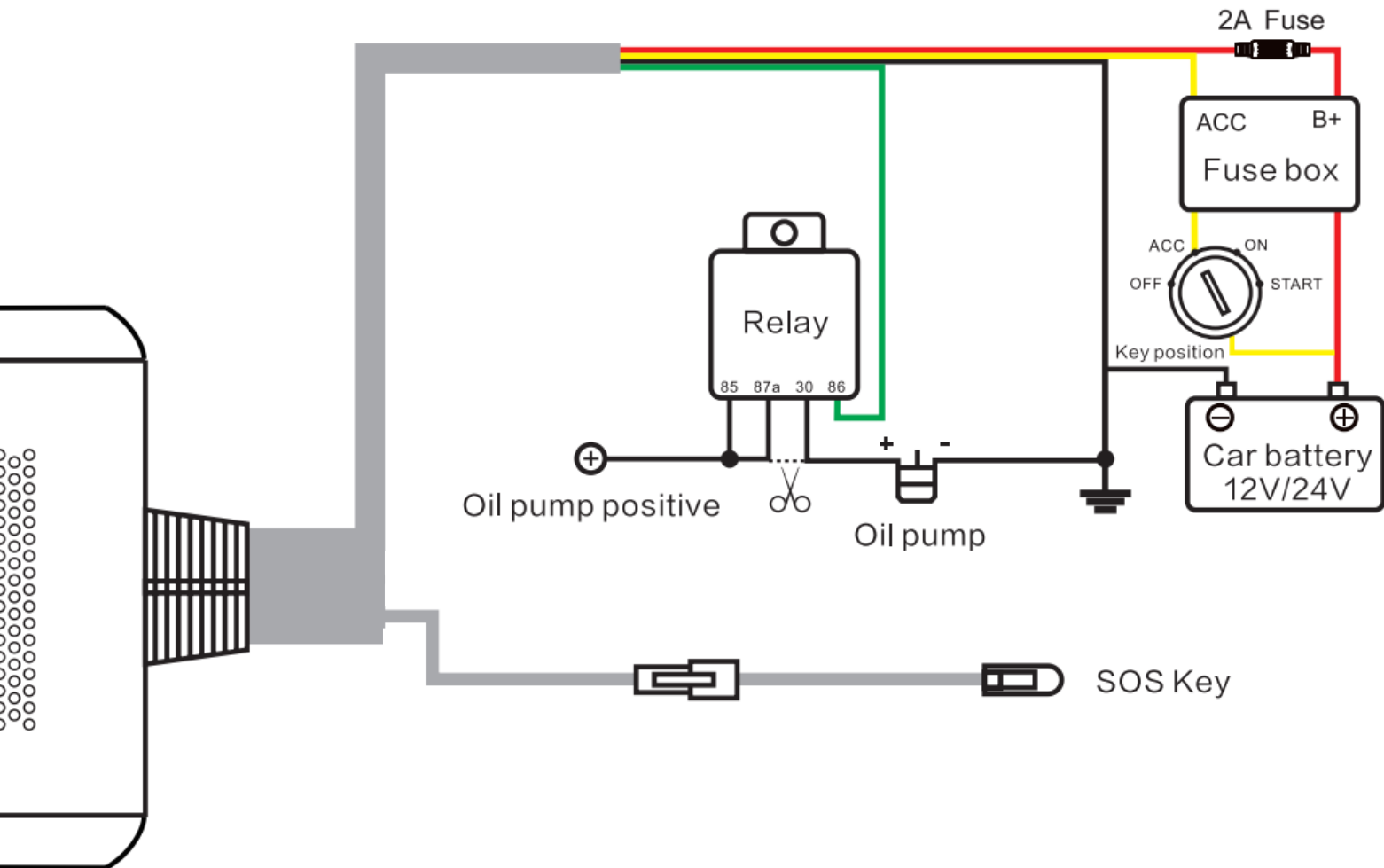

- Please connect the wires when ACC off. Once the wiring is completed, connect the cable bus to the power cord of the camera.



- If the device turned even the ACC is off, it means the ACC line is connected incorrectly. Please check the wiring again.
- Ignite the car and the camera turns on, means the device is connected correctly.

Install SIM & TF Card

- SIM Card Standards: 4G/3G/2G Nano SIM
- Recommend: Lncoon SIM

Before install, you can confirm the following points in advance:

1. The PIN is disabled.
2. There is no restriction of the IMEI# from the operator.
3. The SIM card is with balance and data.

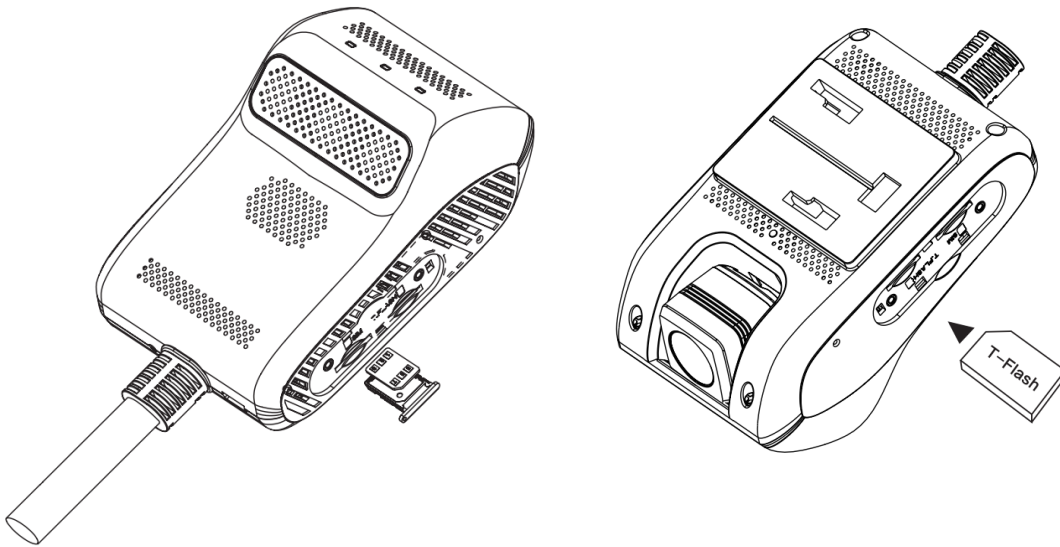

- TF Card Standards: 32GB to 258GB TF Card
- Recommend: 128GB TF Card (FAT32 Speed Class 10)

Install Step:

- ACC off, insert both SIM and TF card into the camera.
- Turn on the car and press the restart button to restart.
- Once the blue led went solid, means the SIM is working.



Download App

- Search “Lncoon IOT” in [App Store](#) or [Google Play](#) to download.

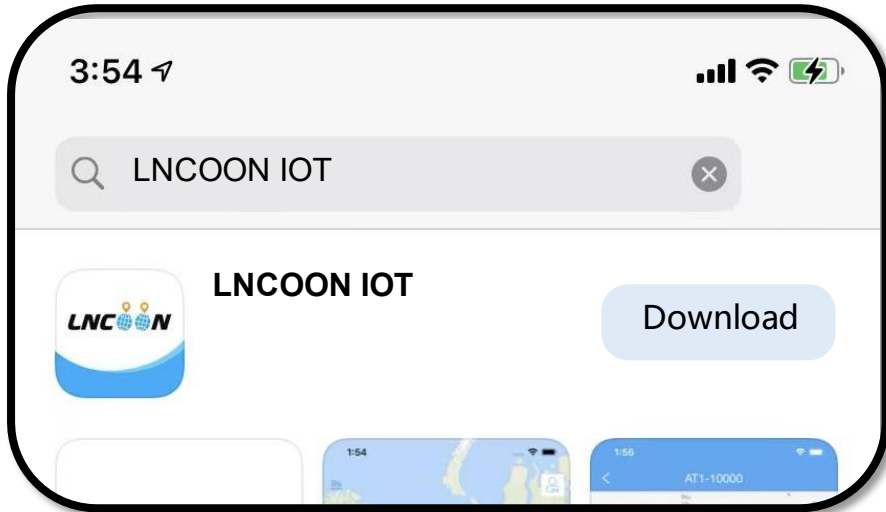

- Visit Lncoon website: Lncoon.com/download to find quick download link.



Sign up & Log in

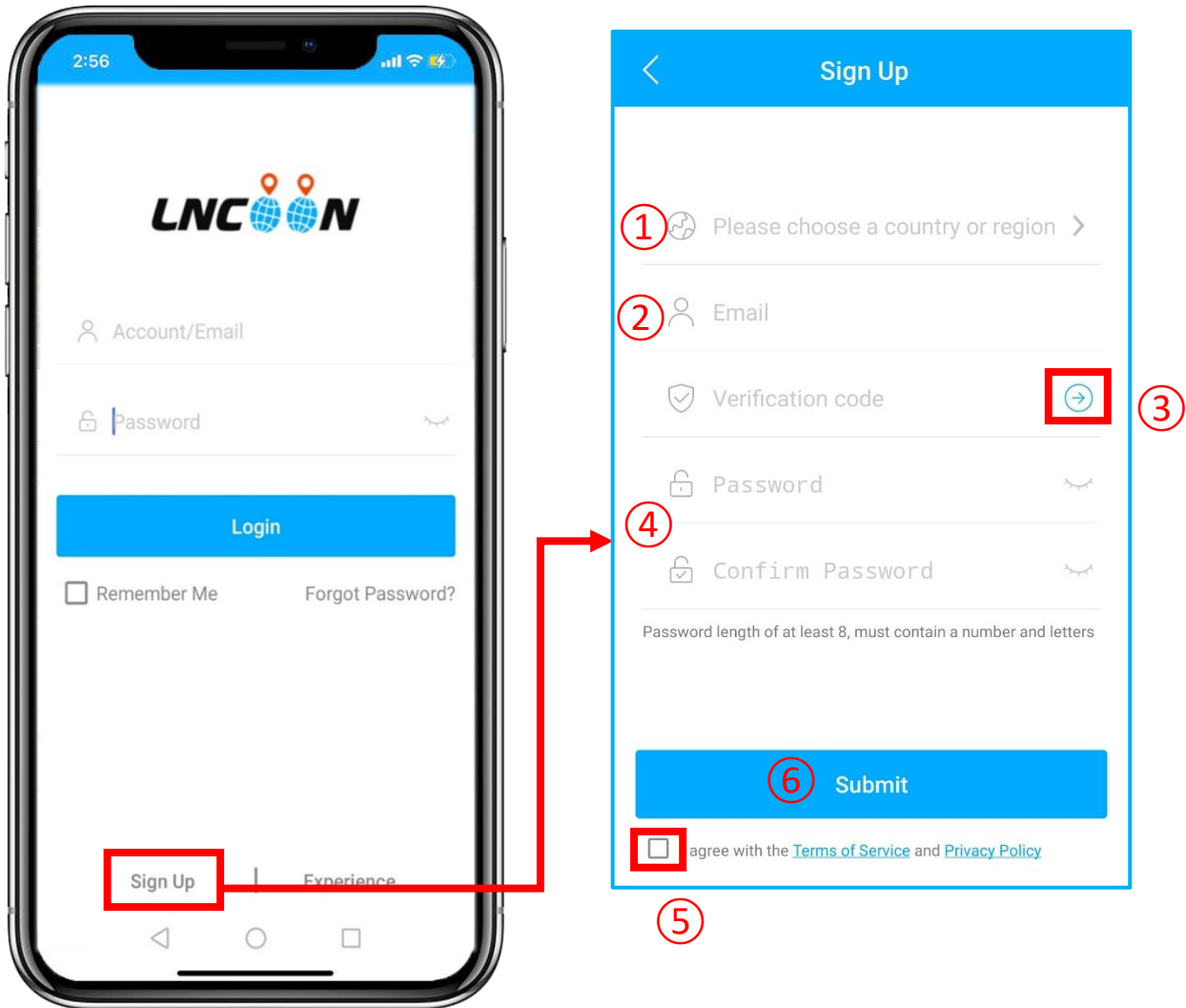

● Click **Sign Up**

- ① Choose your country or region
- ② Enter a valid email address
- ③ Click '→' to get a verification code from noreply@Incoon.com
- * (If no email received, please check the **trash** or **spam**.)
- ④ Set up and confirm Password
- ⑤ Check and agree the terms and policy
- ⑥ Click on **Submit**

*The App will automatically log in to your account, please remember your account and password for future login.

Add Device

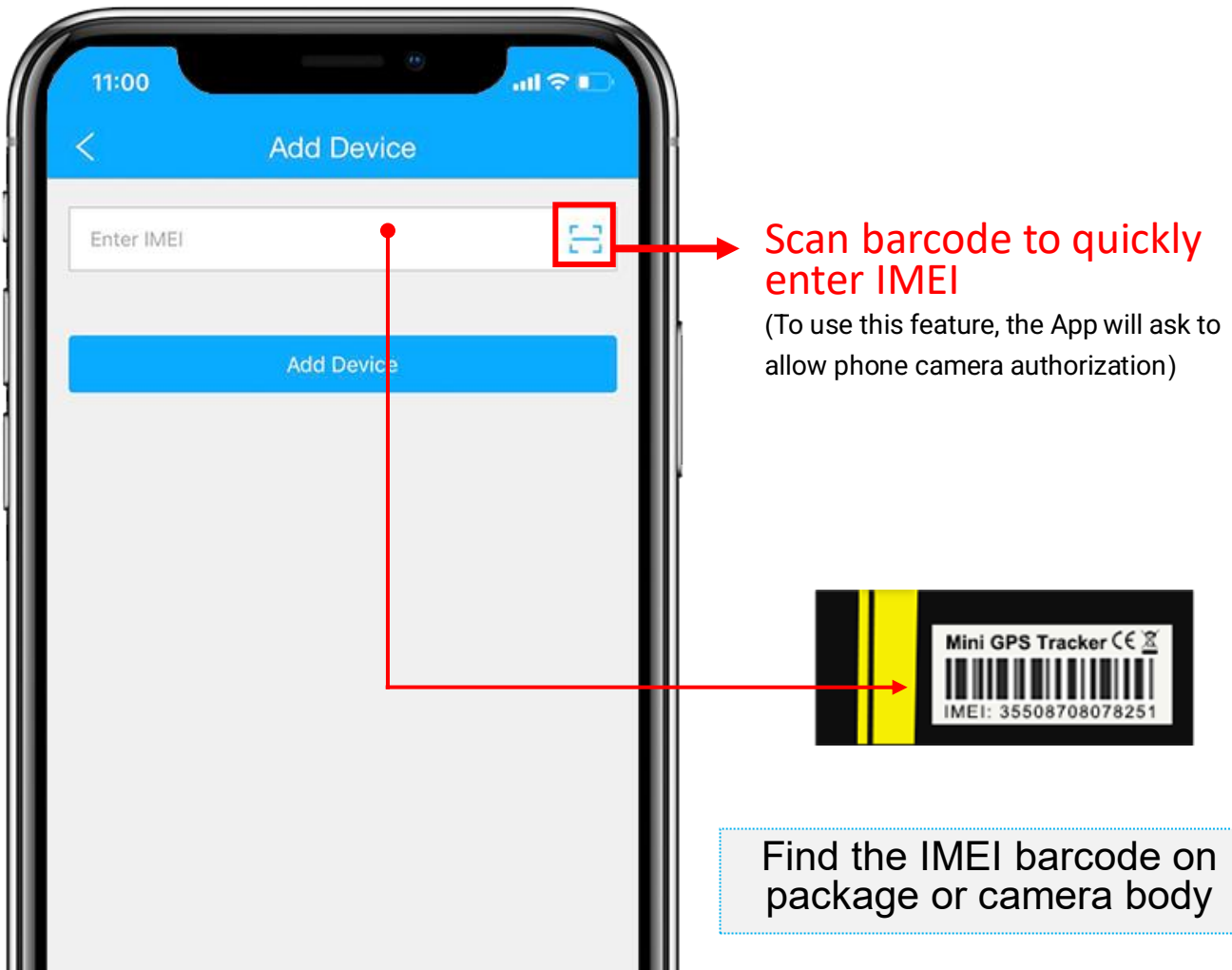
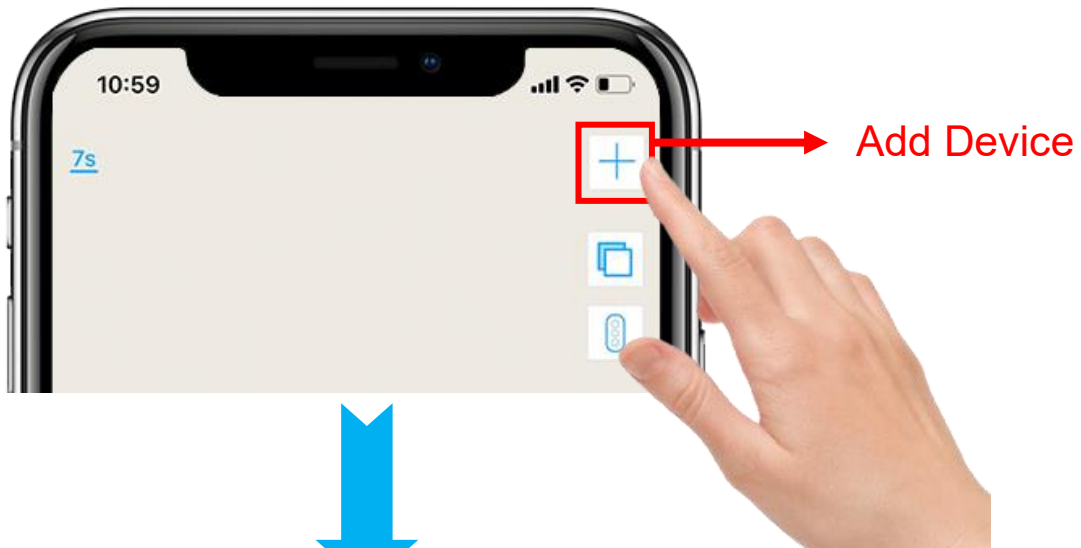

1. Click the '+' on the top right to add device.
2. Scan or type in the IMEI number on the package or device body.

3. Click **'Add Device'** to confirm.

4. Edit basic info about this device, or click on **'Save'** directly to skip this step.

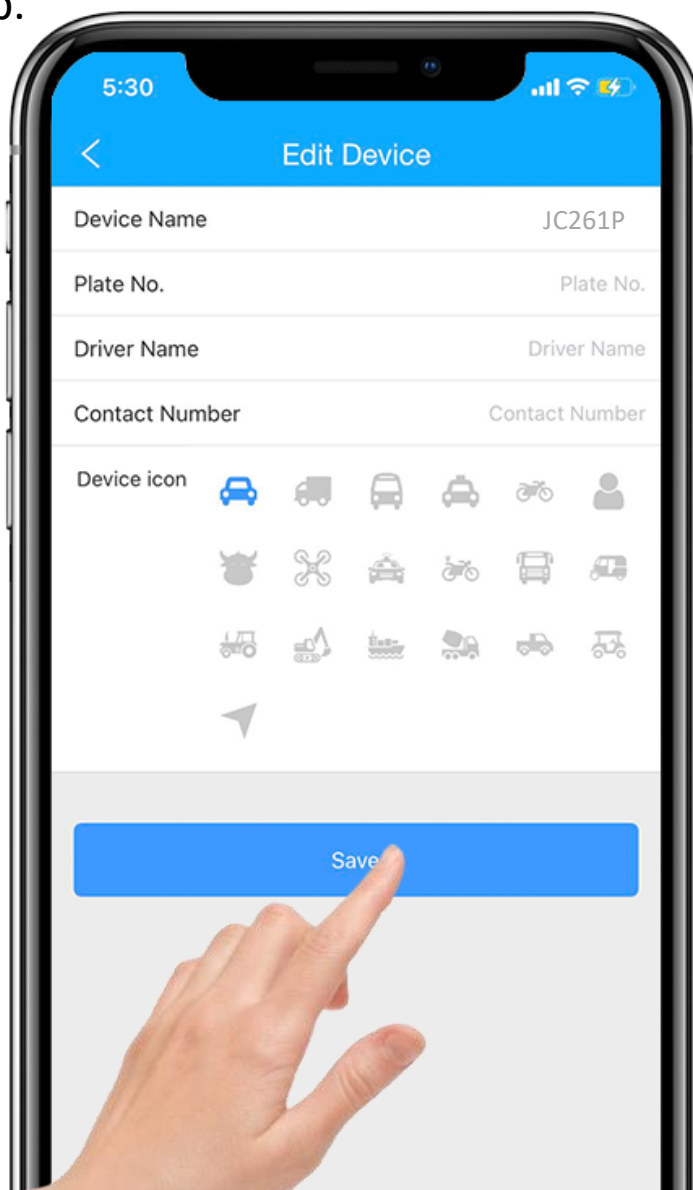

5. You can always come back and edit in the **'Detail'** Page later.

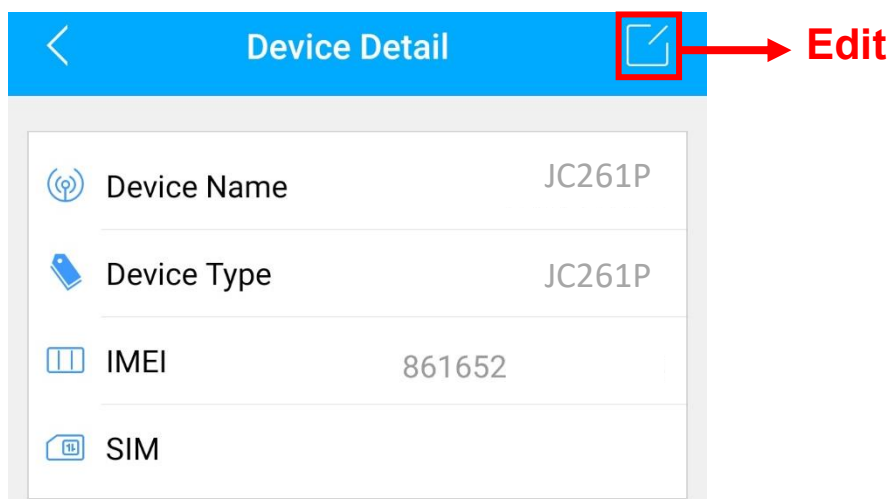

Confirm SIM Connection

- Turn on car engine, and insert a SIM card.
- Long press the restart hole over 5sec to restart the camera, so it can recognize the SIM is installed.



- Check and wait for the **blue LED** went solid on. If the **blue LED** keep flashing, please drive to open area for better cellular signals.
- If the **blue LED** is solid on, but the camera still shows inactive. Please try send SMS to the SIM inside the camera with APN command:
 1. For AT&T SIM, please copy and send:
`APN,NXTGENPHONE,NXTGENPHONE,310,410#`
 2. For T-MOBILE SIM, please copy and send:
`APN,fast.t-mobile.com,fast.t-mobile.com,310,260#`
If still not working, then try send:
`APN,epc.tmobile.com,epc.tmobile.com,310,240#`
 3. For VERIZON SIM, please copy and send:
`APN,vzwinternet,vzwinternet,310,12#`

*If the network company is not list above, please contact us to help you setup

Ensure Device Online

1. Go to 'List', you will see the JC261P you just bind.
2. You can tell the status of the device via the color of the icons.
3. When the icons displayed in **green** or **orange** or **red**, it means the device is **online**.

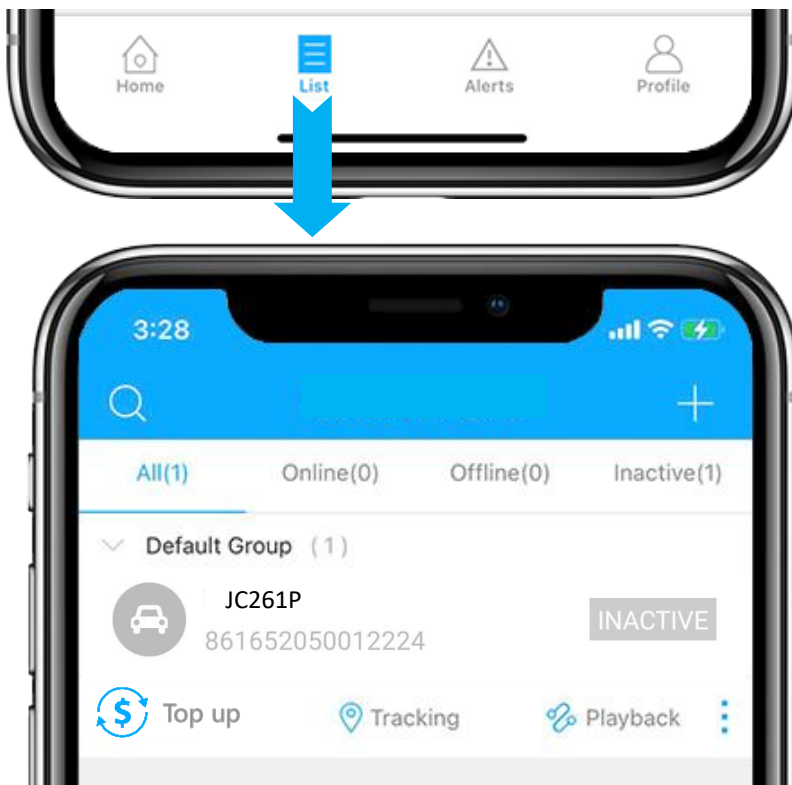

Status Indicator

ONLINE

IDLING

STOPPED

INACTIVE

OFFLINE

Device Inactive

- Check the [LED indicators](#) and [contact us](#).

Device Offline

- Check whether the device is well connected to the power supply.
- Check whether your SIM card balance has been used up.
- Check the [LED indicators](#) and [contact us](#).

Install Camera

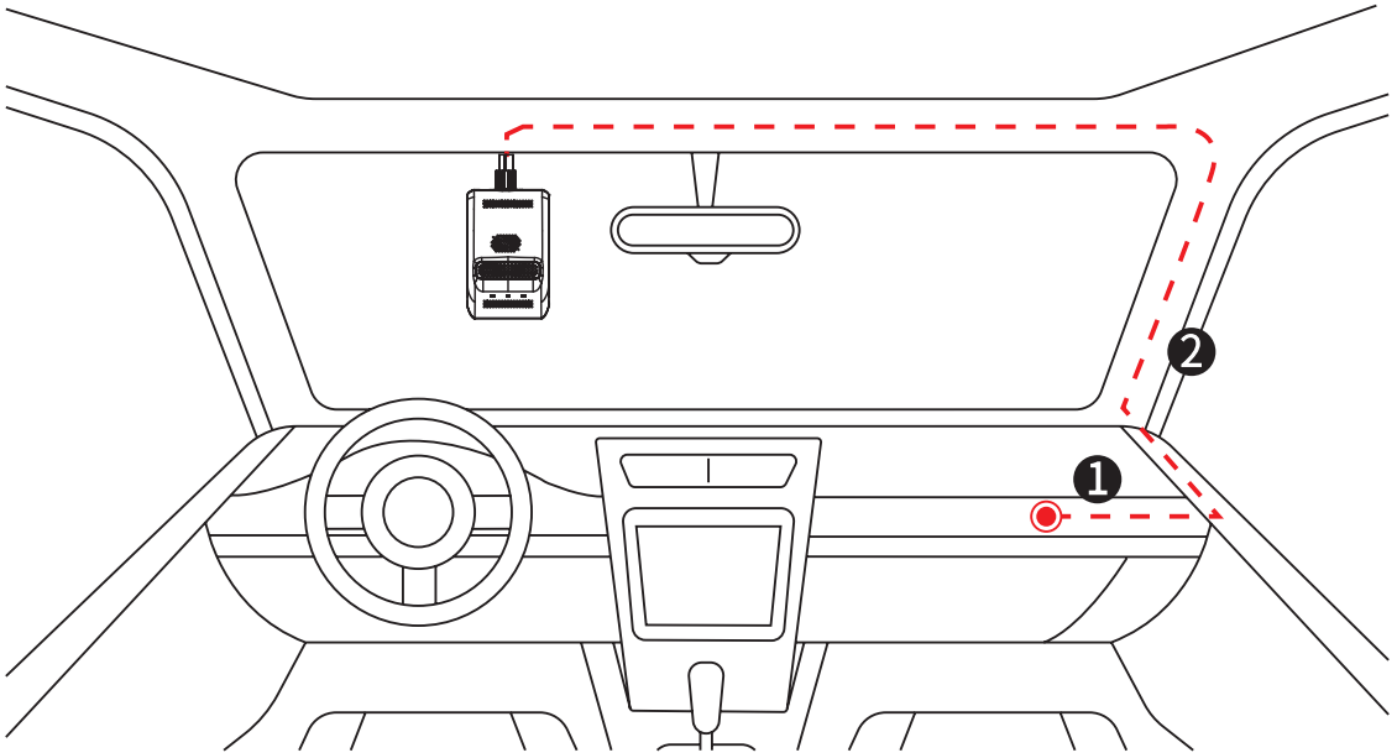

1. Wind the connected hardwire wire to the top of the windshield along the red dotted line.
2. After confirming the installation position of the camera, bury the cable into the lining of the car to fix the power cable.

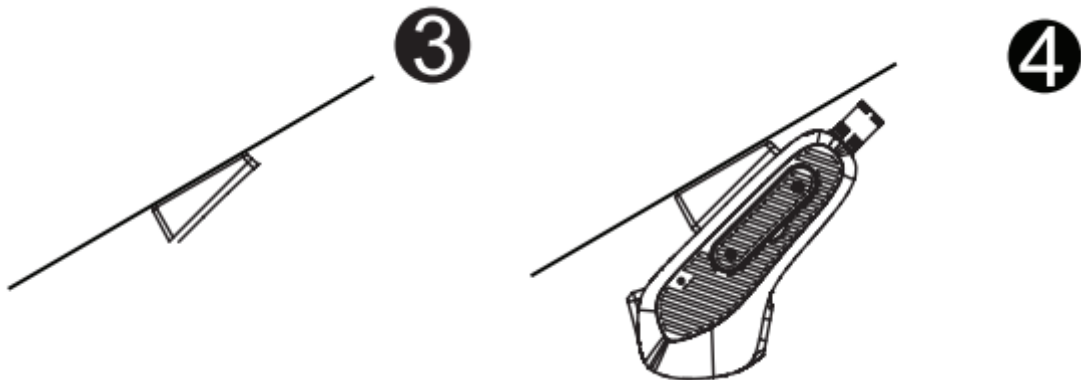

3. Wipe and clean the windshield, and then attach the 3M mount to the windshield.
4. Install the camera on the mount.

Install Accessories

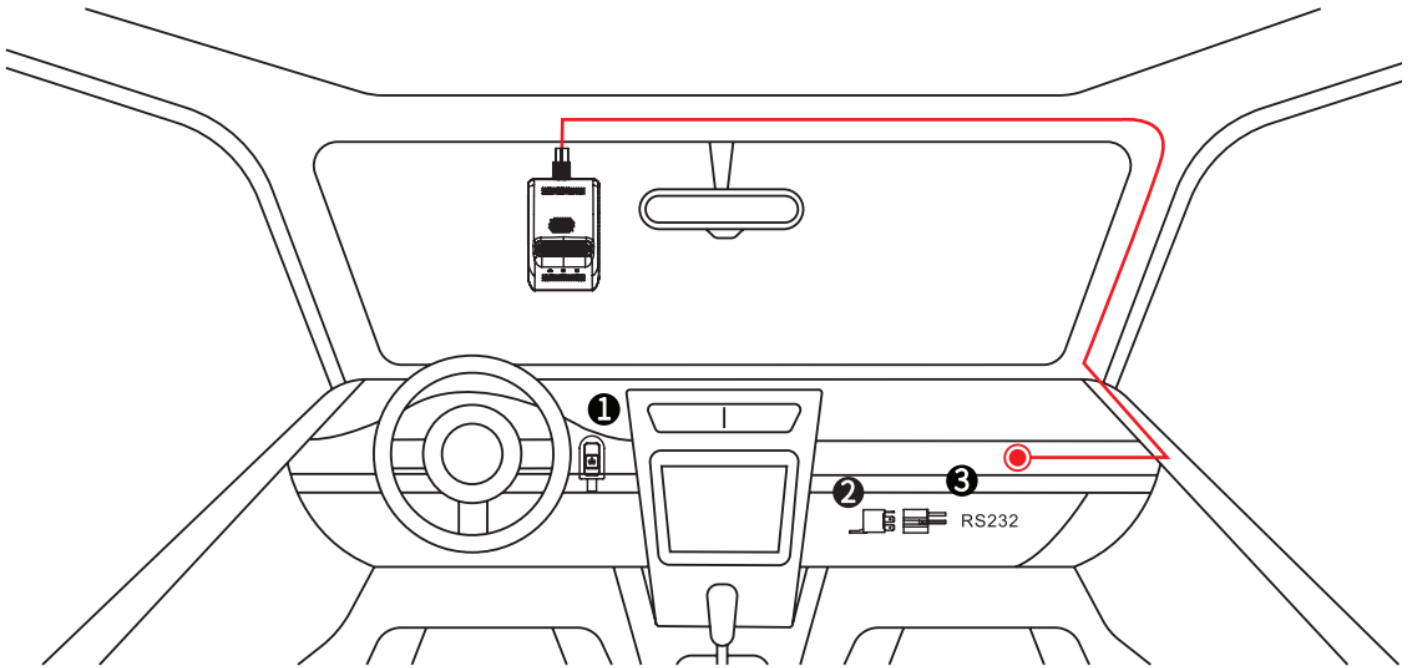

- SOS key:

It is used to seek help in emergencies. Connect the SOS key to the corresponding interface on the device, remove the protective film from the 3M tape, and then attach it to a proper position (such as ① in the above figure).

- Relay:

It is used to cut off the power and fuel of the vehicle remotely to force it to stop (only when the moving speed is lower than **20km/h or 12.4mph**). Connect it to the corresponding interface on the device and place it in a proper position, such as ② in the above figure.

Set up with WiFi Kit

- Download wifikit in [App store](#) or [Google Play](#)



- Check WiFi Kit Video [here](#) to set up.
- How to connect camera's wifi
 - Open wifikit, click the “connect wifi” button will redirect you to the wifi setting page.
 - Near the camera you will see a wifi hotspot named as camera's IMEI number.
 - Connect the camera, the password will be the last 8-digit of the IMEI number.

Get Help

- Live chat with us by clicking the service icon
- Email: amazon@jimiiot.com
- Messenger us on Facebook: m.me/Incoon
- Check the FAQ Library on website: Incoon.com/FAQ



App Instruction

● Bottom Menu

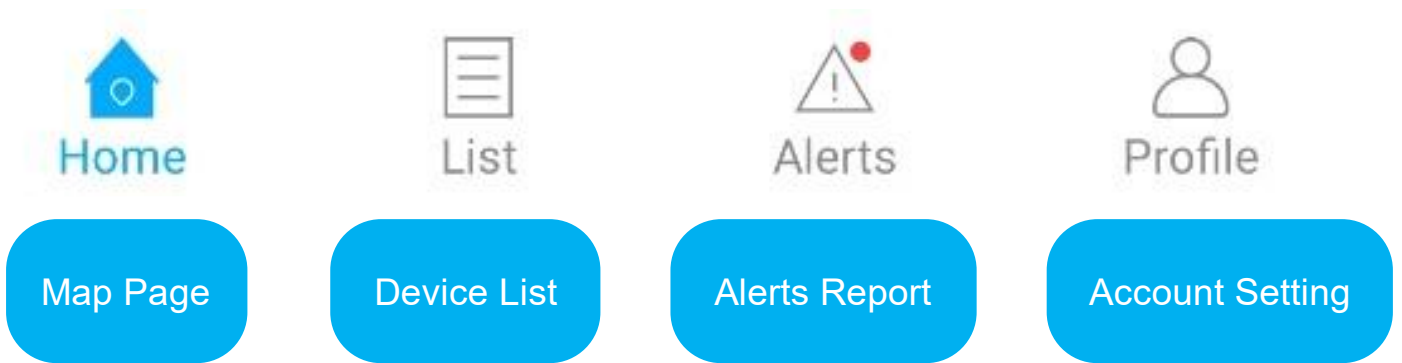

● Console Menu

1. Tapping the icon to check the device.
2. Tapping the  button to expand the menu.

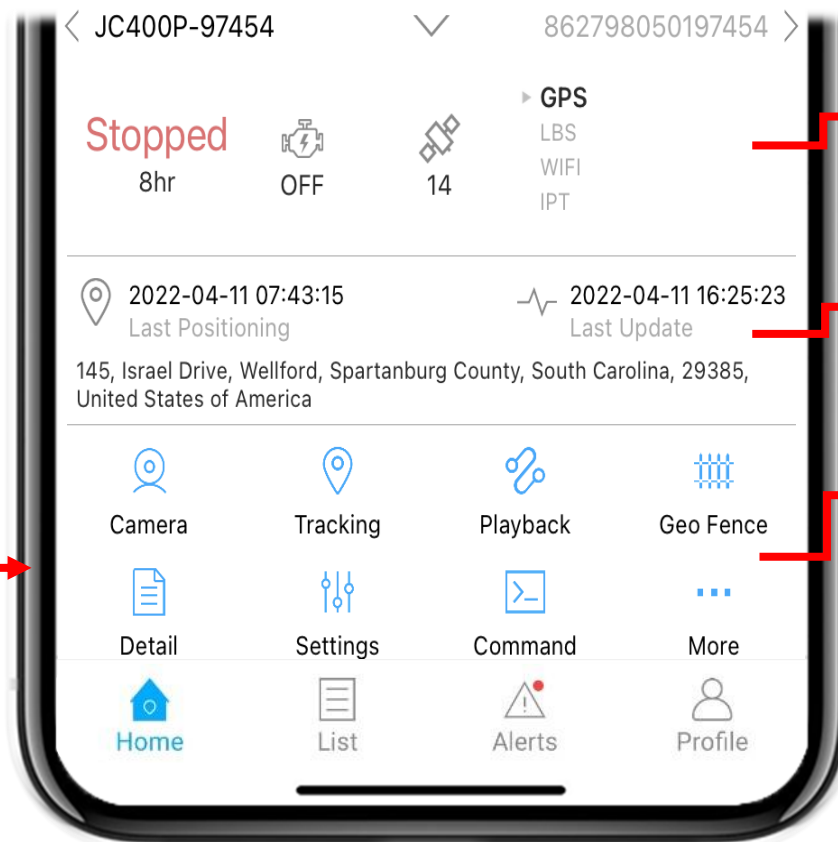
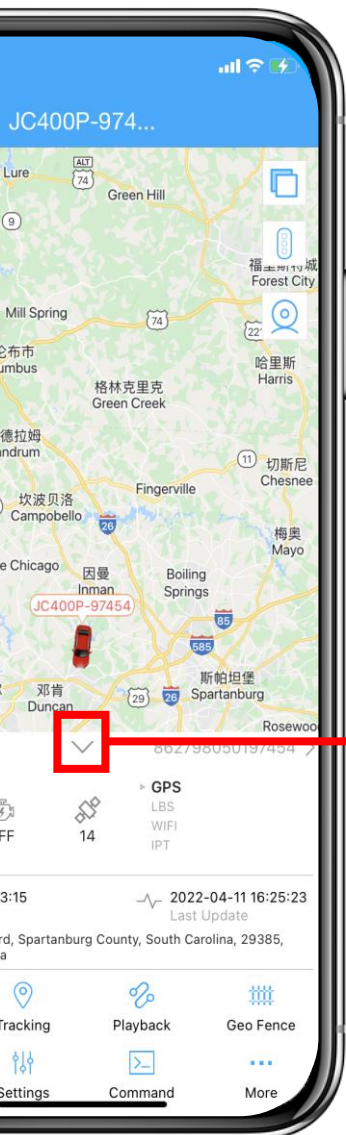

Note:

If there is no map display, please install Google Maps app.

Media Center



Camera



Tracking



Playback



Geo Fence



Detail



Settings



Command



More

- Tapping on 'Camera' to enter Media Center.

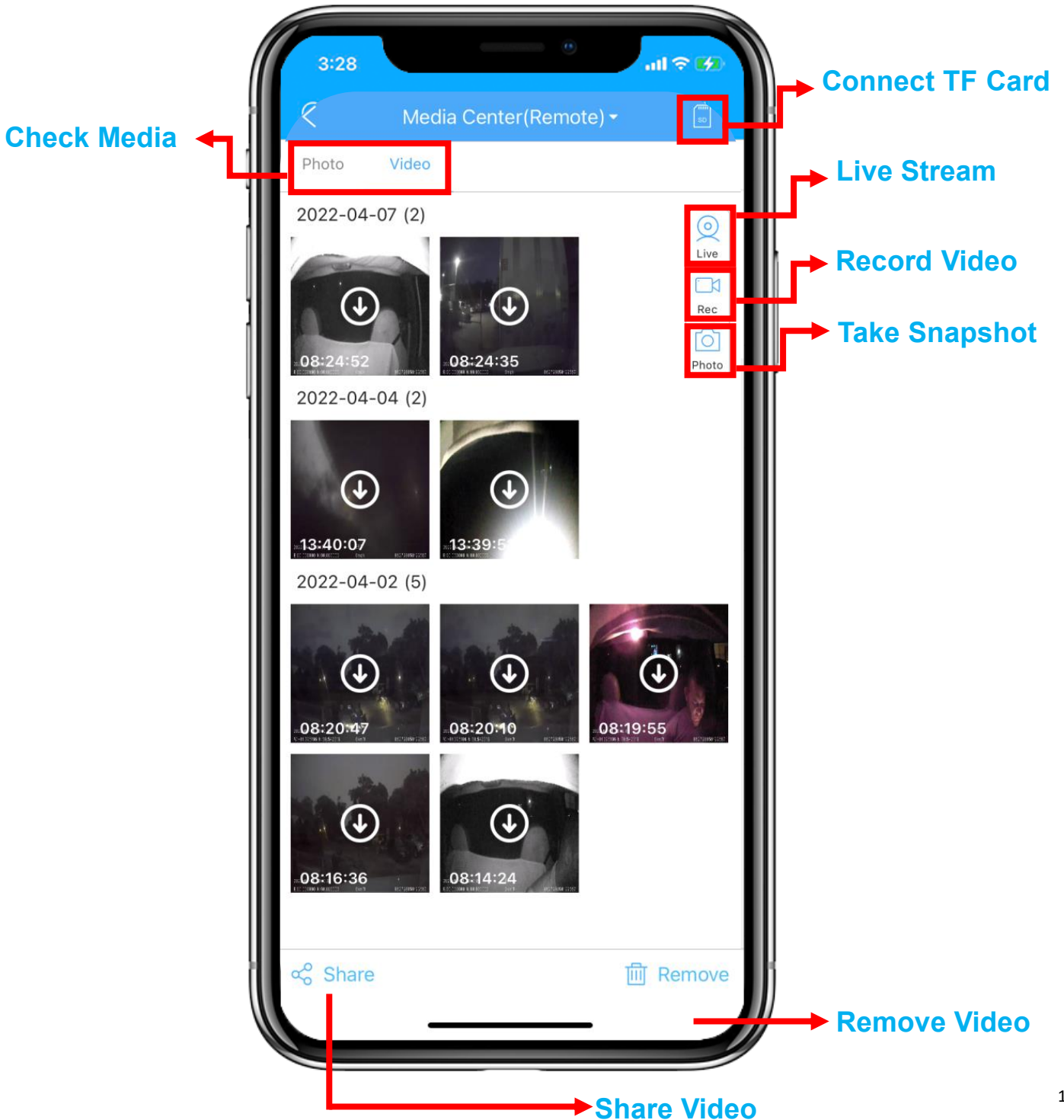

Live Stream

- Tapping on 'Live' on Media Center to check live video.

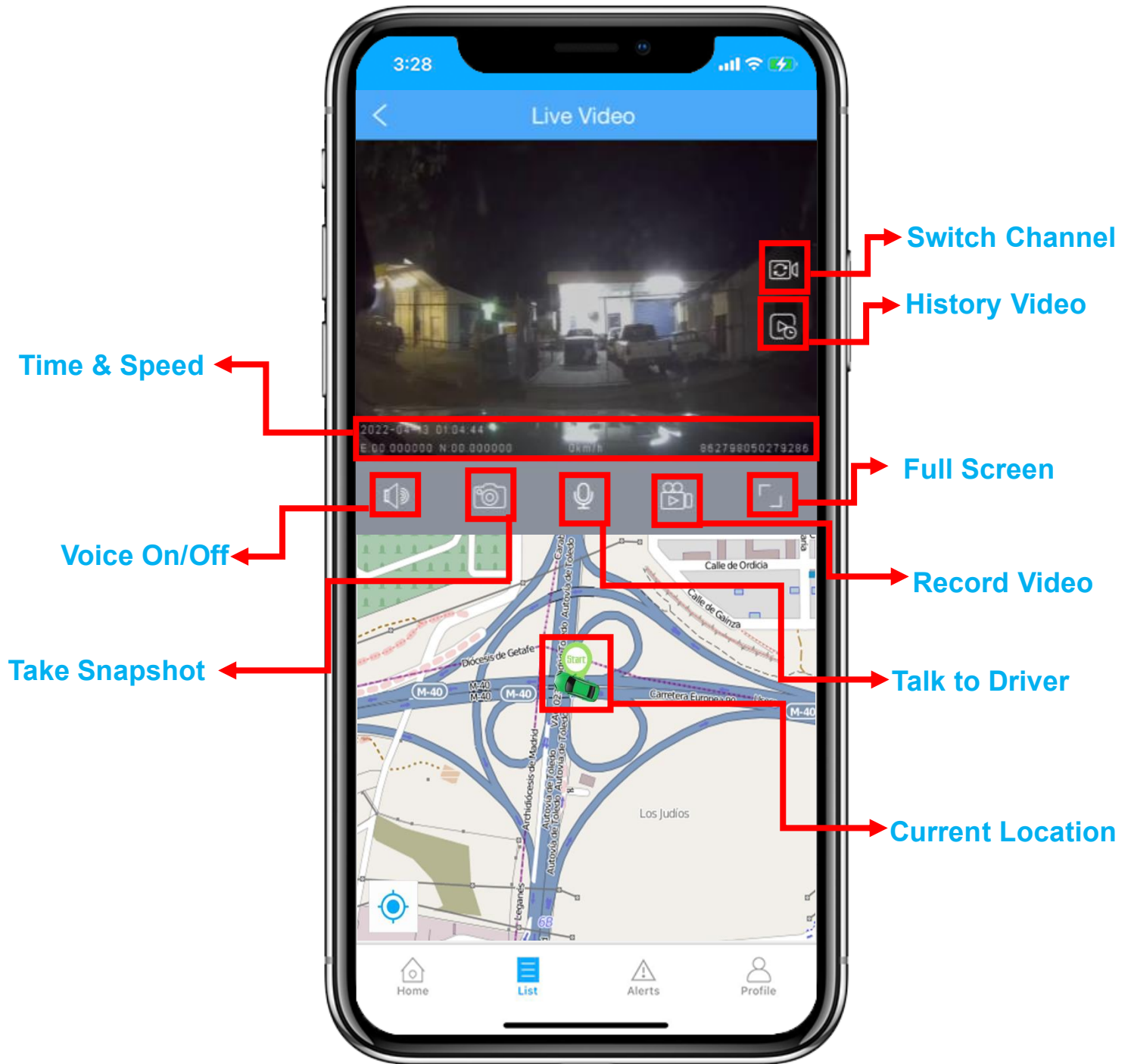

To check multi-channel of multi devices, you can login on LNCOON web platform: <https://us.Incoon.com>

Event Video Setting

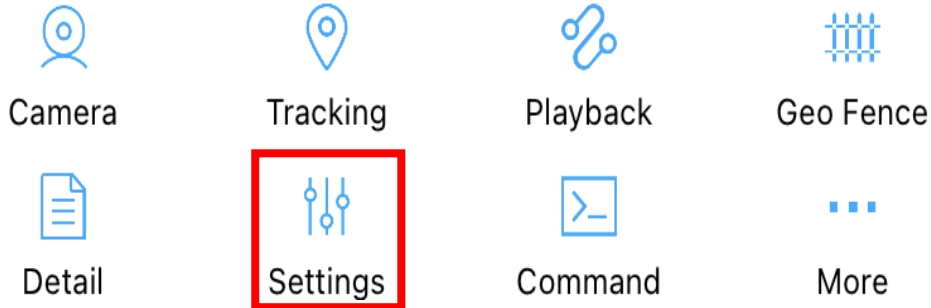

● Tapping on 'Setting' to turn on/off event video.

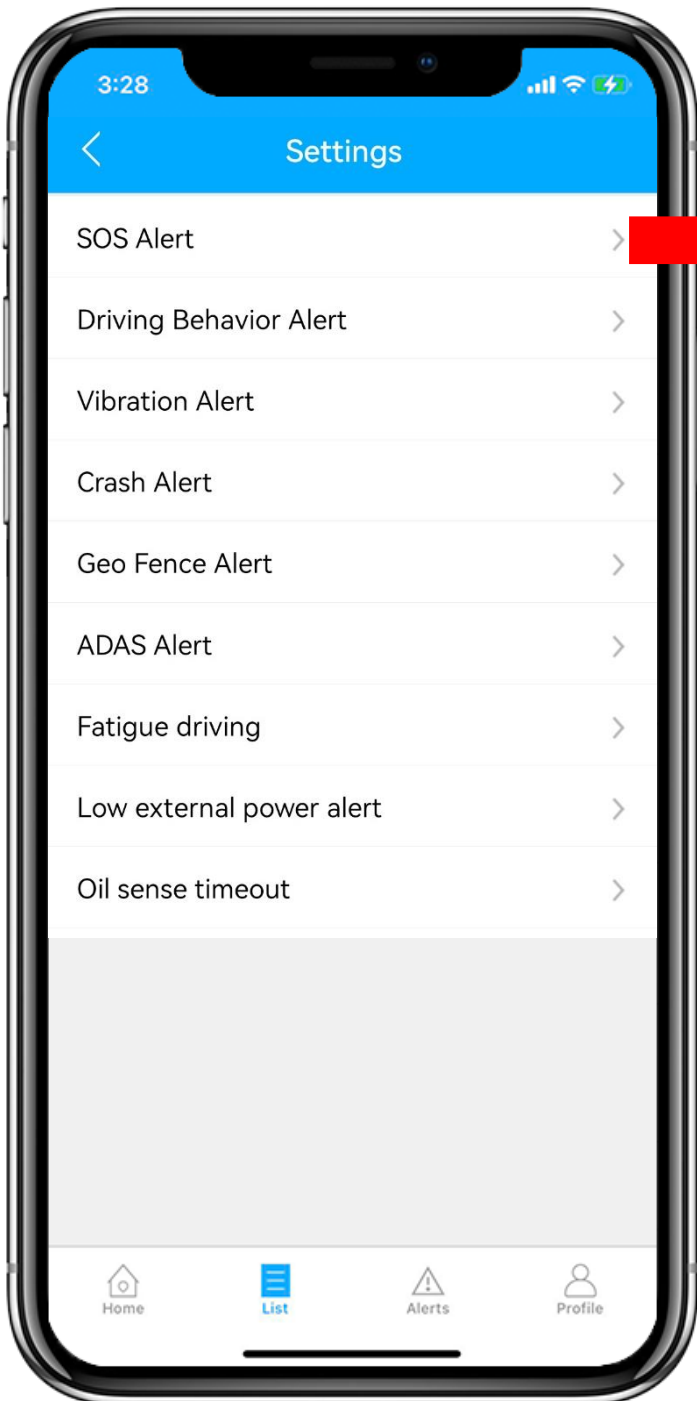

Real Time Tracking

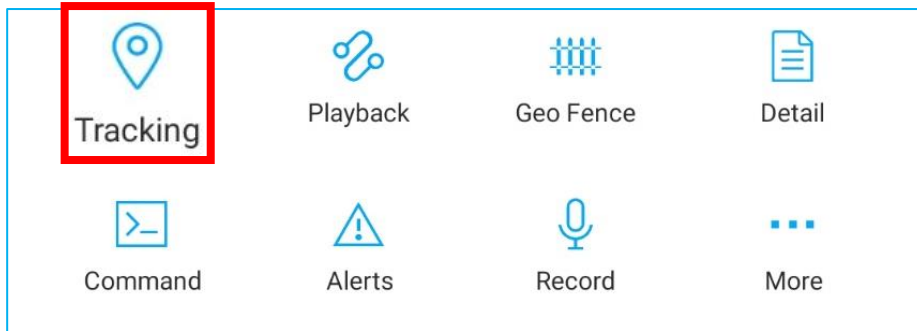

- Tapping on 'Tracking' to enter tracking page.

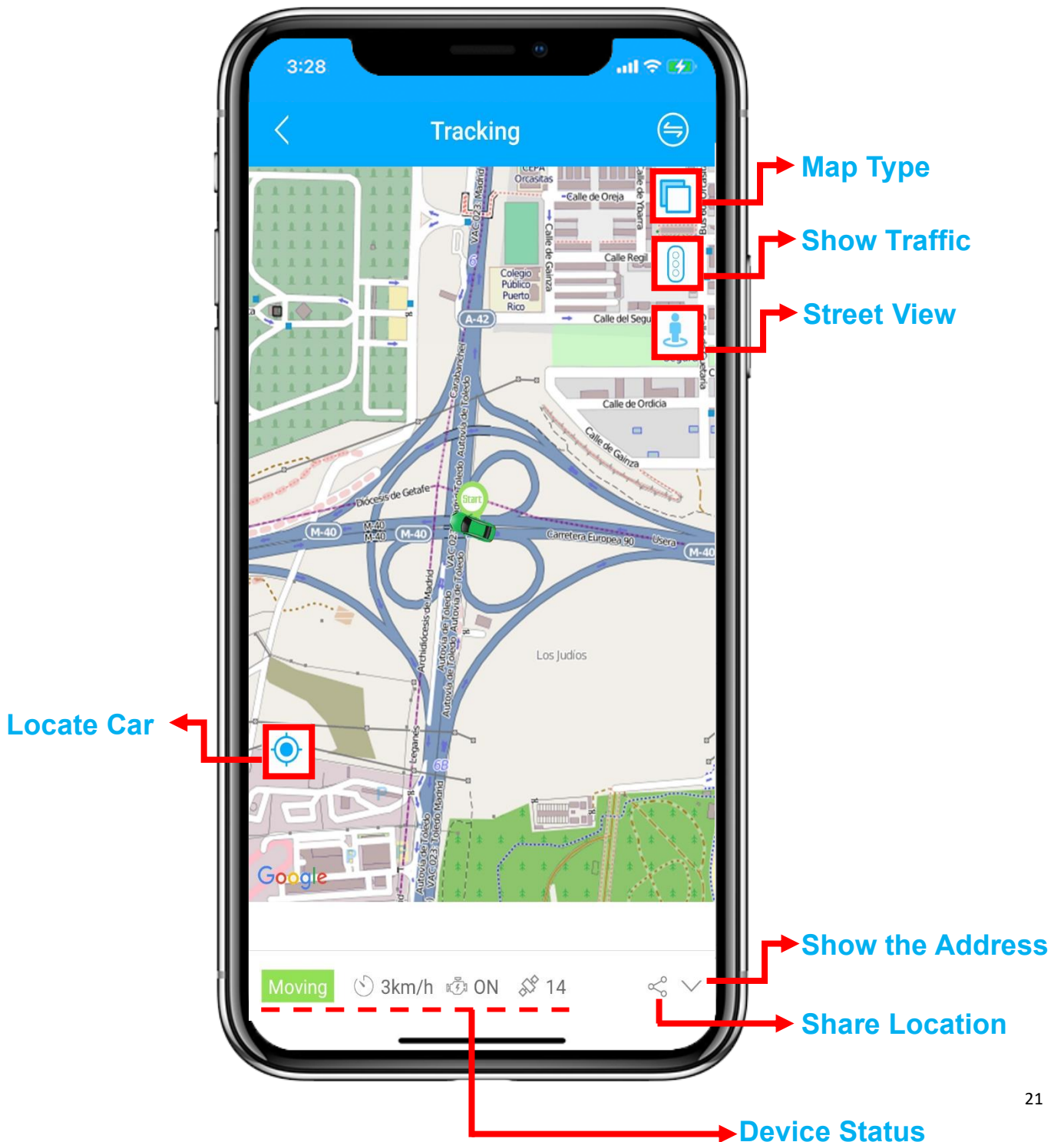

History Playback

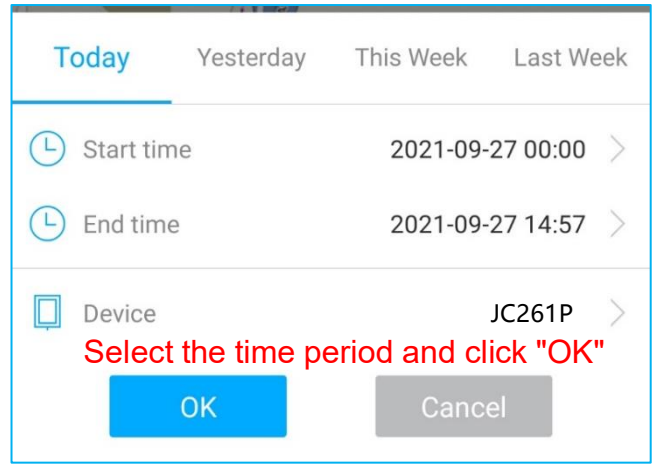
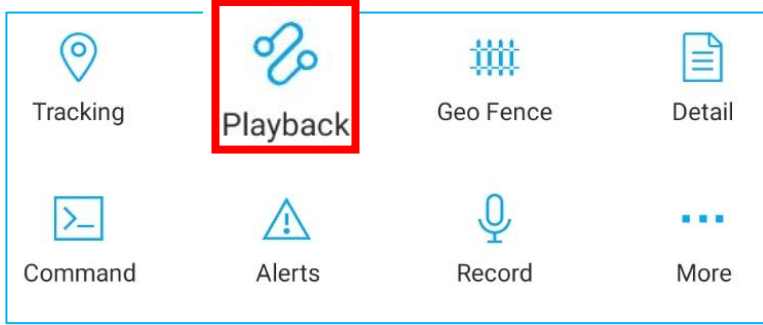

● Click 'Playback' to search the historical trips.

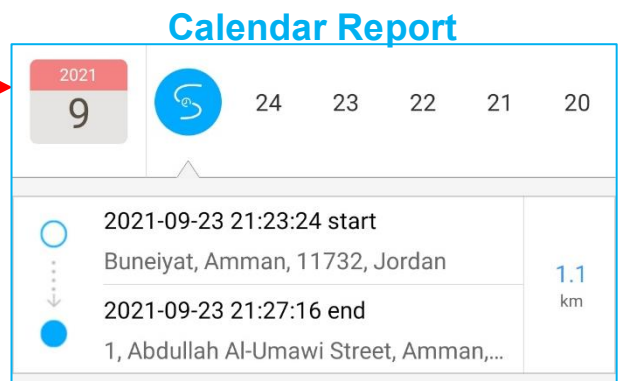
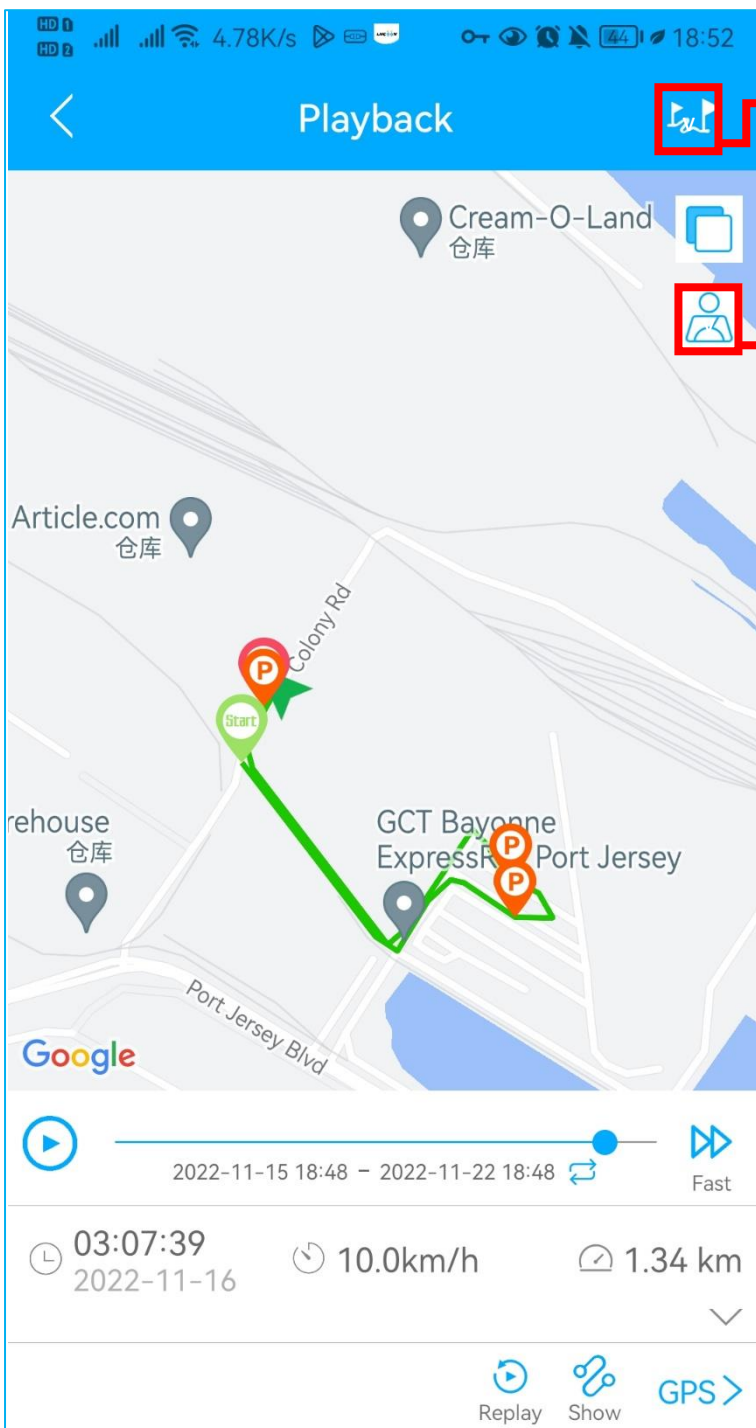

Play & Pause

Speed up
Slow

Hide / Show the line
Hide

Choose another period

Geo Fence

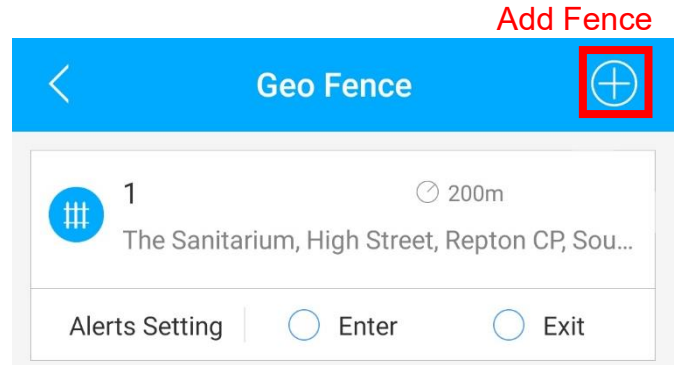

● Click 'Geo Fence' to manage your customized fences.

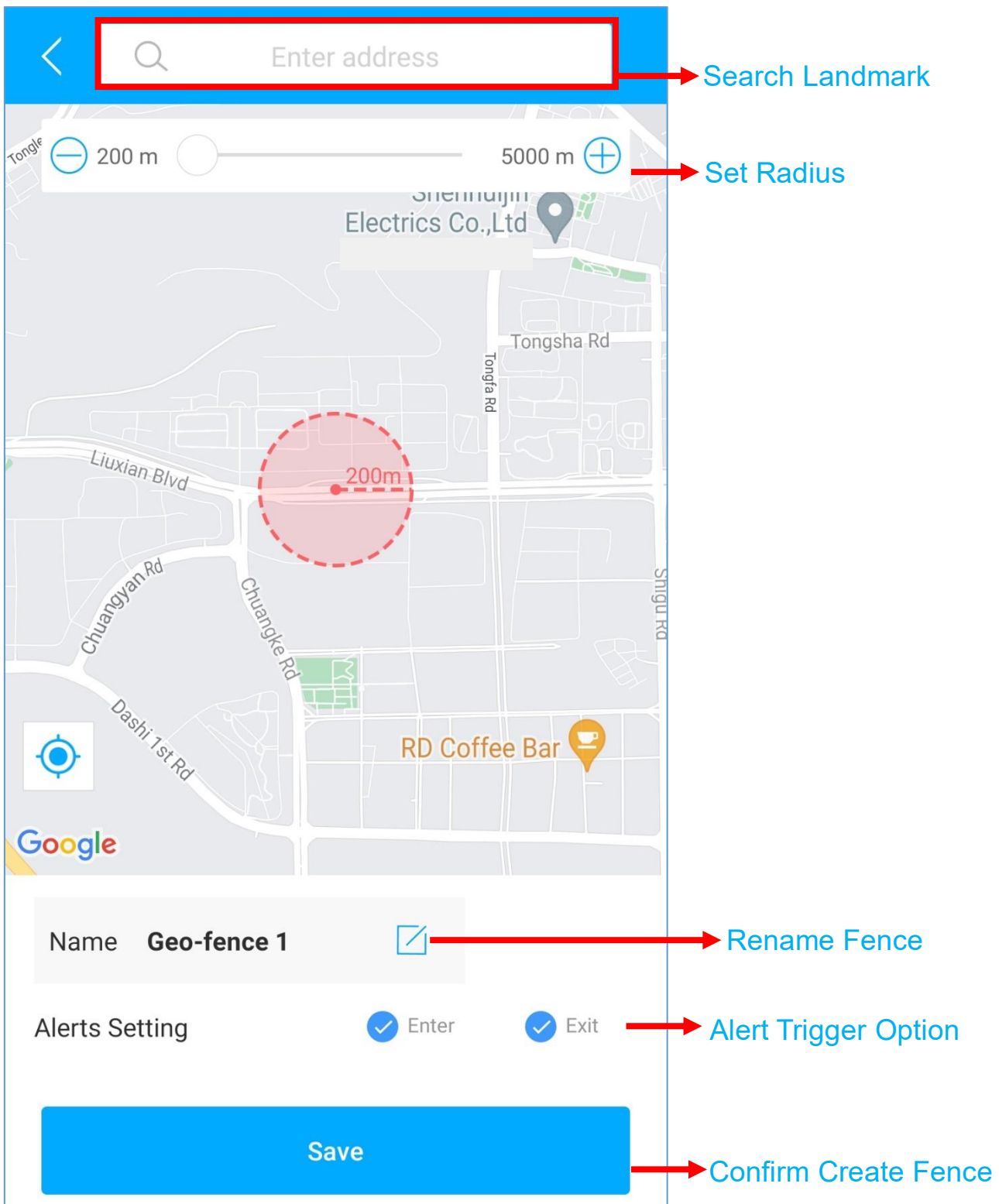

Alert Setting

- ① Find your device in the list page, click on the  icon.
- ② Go to 'Command' page to set alerts based on different situations.
- ③ Explore more setting options to design your own tracking style.

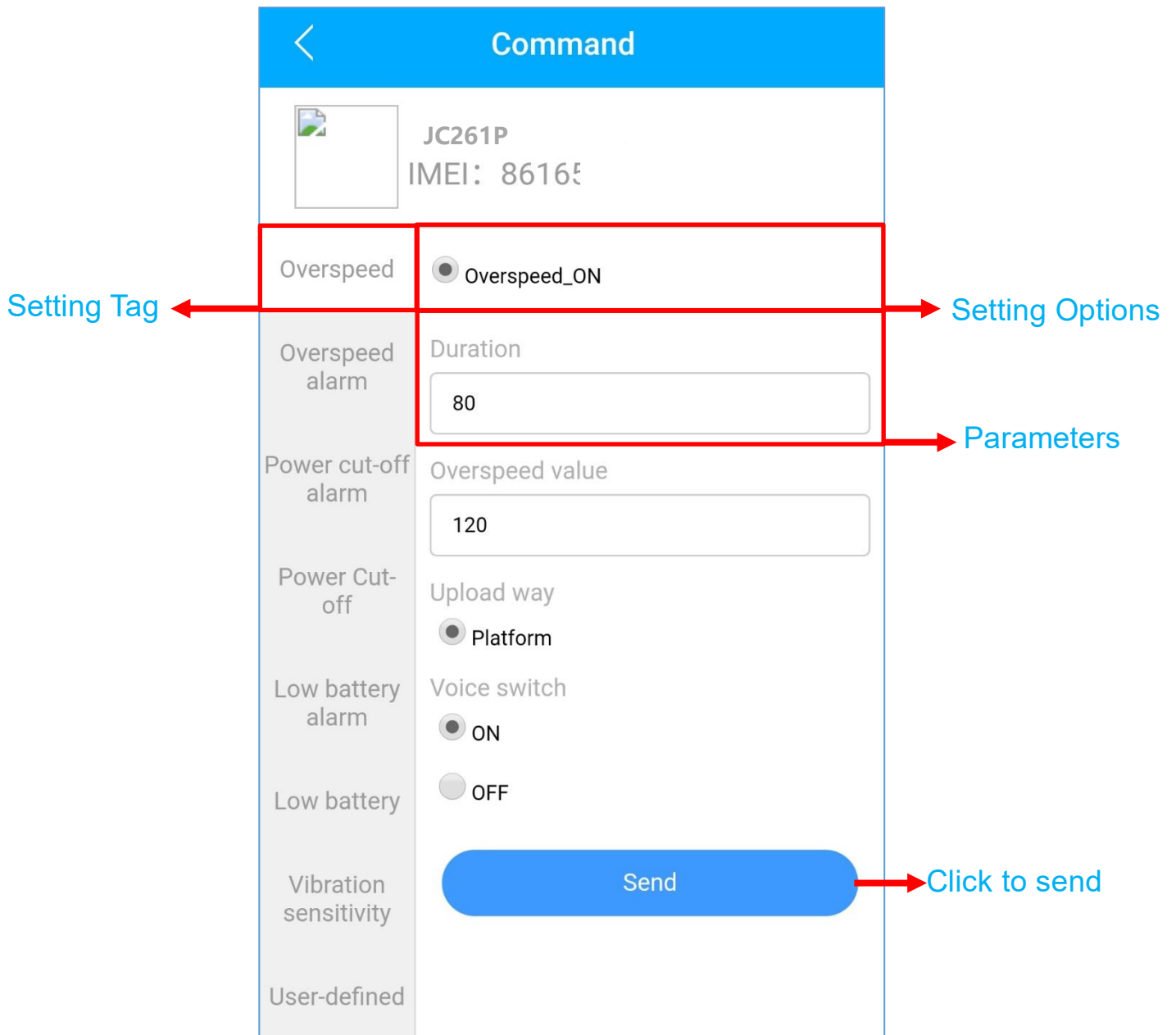

- These commands can only be affected when devices are online.
- If you are confused about these settings, please feel free to [contact us](#).

FAQ

Q: There is no device on the map, only a blue dot shows the location of my phone.

A: 1. Make sure the device is **fully charged** and **powered on**;

2. Make sure you have a **valid subscription plan**;

3. Check the "**List**" page to make sure the **device is online**;

*(The icon in red, orange or green means it is online)

4. Bring the device to an open sky, so that the device can **obtain better GPS signals**.

Q: Can't receive any push notifications after the alarm is triggered

A: Check whether the "**Alert**" page has corresponding **alarm records**.

- **If yes:** please click the **logout** button in the upper right corner of the Profile, and try to **log in again**.

- **if no:** 1. Please check the **online status** and **network status** of the device.

2. Please click the  button in the upper right corner and make sure you **don't filter out** any alarms.

3. Please try to check and **setup the alert again**.

Q: The device disappeared from the "List" page.

A: please click the **logout** button in the upper right corner of the Profile, and try to **log in again**.

*If you have any other questions, click the  icon to get technical support.

LED Indicators

(1) Power Status (Red)

| Status | Meaning |
|--------------------------|---------------------------------------|
| On for 0.5s; Off for 10s | In Sleep Mode |
| On for 1s; Off for 1s | No TF Card Detected / TF Card Damaged |
| Solid On | Power On |
| Off | No Power Connected |

(2) Network Status (Blue)

| Status | Meaning |
|-----------------------|--|
| On for 5s; Off for 1s | Network Connection Failed |
| On for 1s; Off for 1s | Network is Available & Connecting Server |
| Solid On | Connection Succeeded |
| Off | Network Unavailable / No SIM Detected |

(3) GPS Status (Green)

| Status | Meaning |
|-----------------------|--------------------------|
| On for 1s; Off for 1s | Searching for GPS Signal |
| Solid On | Positioning Successful |